

***BA16-CRCZ***

coway

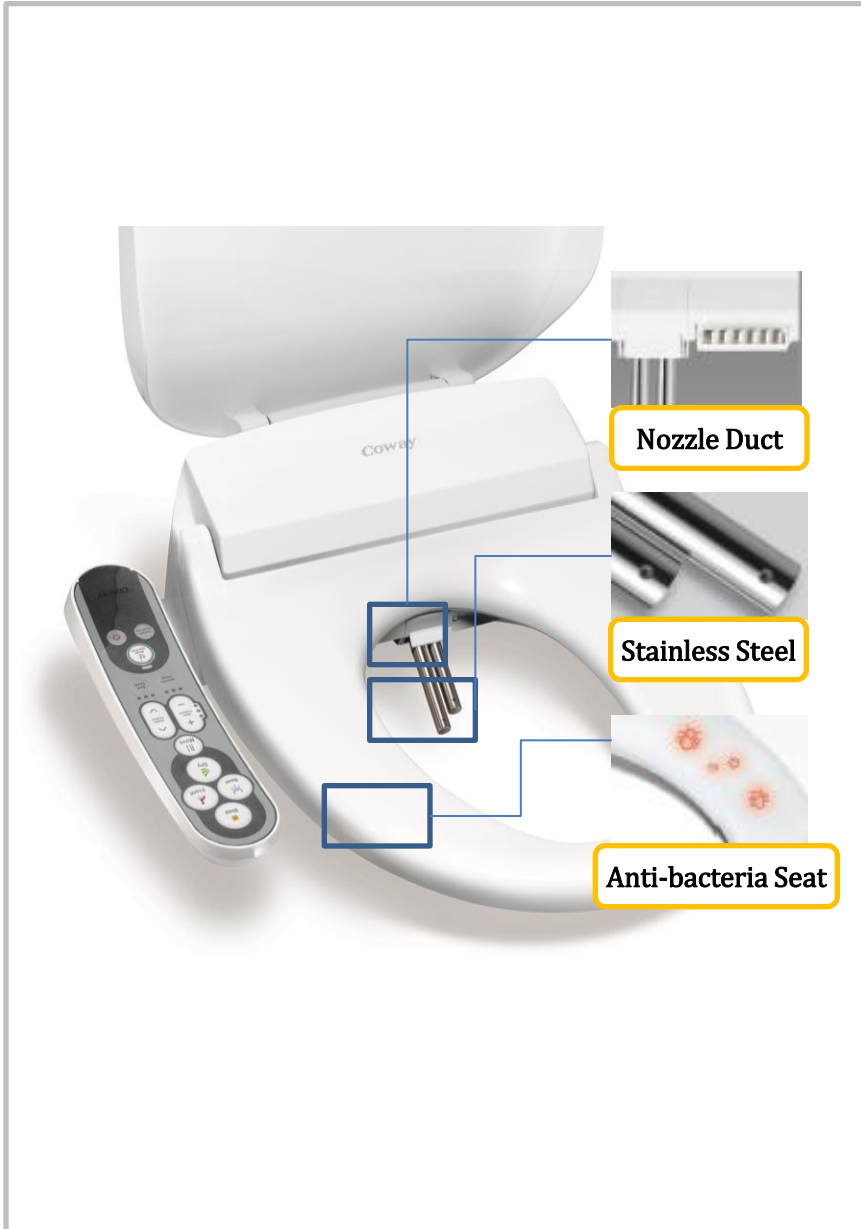

Specification	
	<p><b>1. Easy-to-Clean Nozzle Duct</b> Nozzle duct can be replaced and cleaned easily.</p>
	<p><b>2. Hygienic Stainless Steel nozzle</b> Hygiene can be ensured with self cleaning stainless steel twin nozzle.</p>
	<p><b>3. AIR+ Water</b> Air pump injects bubbles into the water stream for gentle and stronger cleansing.</p>

# SPECIFICATION



Items	BA16-CRCZ
Size	494 X 534 X 150 mm
Weight	5.3 kg
Power consumption	Max. 1,050W
Nozzle	Stainless Steel Twin nozzle
Water pressure (cc/min)	400/500/600
Language Manual	English, French, Czech
Water / Air / Seat Temperature	4 STEPS
AIR+ Water flow	Air Pump
Heating	Sheath Heater
Nozzle Movement	●
Air dryer	●



# Modified points from BAS-16



## >> BA16-CR (Round shape)

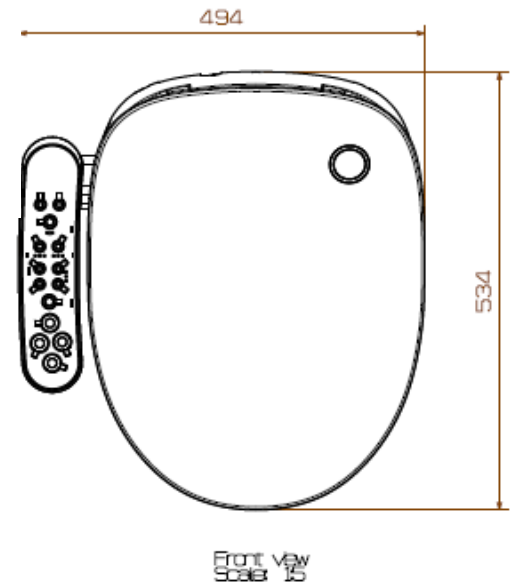
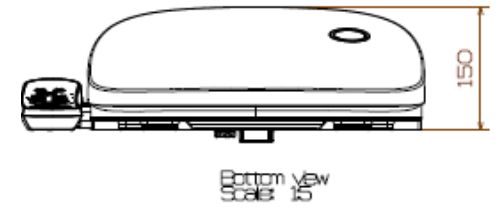
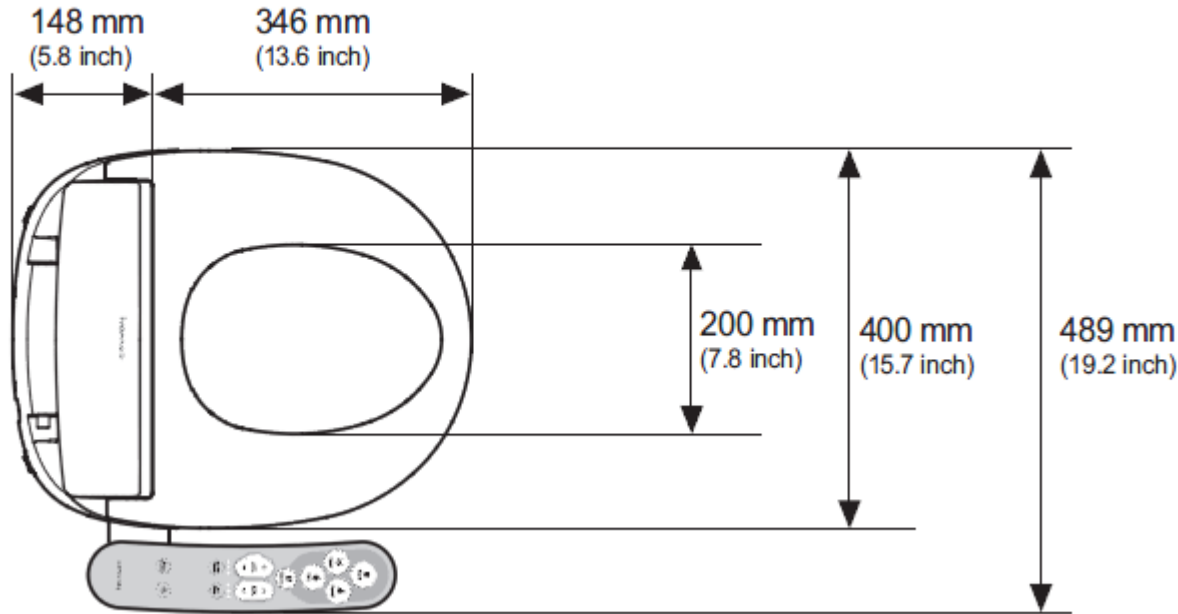

### >> Bottom view

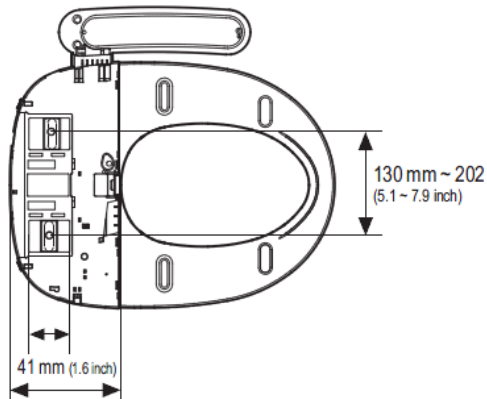

Rear fixing distance : 179 mm (7 inch)

### >> Distance between fixing holes

